

SWINGER POSTER



The Swinger posters have been specially developed with an easy-to-use panel insert system that uses a magnetic strip to create a tight seal.

FEATURES & BENEFITS:

- Easy top loading, magnetic frame panel
- Available in A1 and A2 portrait format
- Black base and oval support tube
- Supplied with two high quality graphic
- Interchangeable graphics
- A1 comes with water base and A2 has a solid rubber base
- Metal bar is available in black or white.



* Product may vary from image shown, Please note that the unit comes standard with a black panel with no header graphics.

HARDWARE SPECIFICATIONS:
Assembled Dimensions (mm):
940 (h) x 600 (w) x 520 (d) - A2 1191(h) x 774 (w) x 600 (d) - A1
Weight:
A1 14/kg - Unfilled A2 15/kg

GRAPHICS SPECIFICATIONS:
Recommended Graphic Dimensions:
841 (h) x 594 (w) [A1 Portrait] 594 (h) x 420 (w) [A2 Portrait]
Visible Graphic Dimensions:
831 (h) x 584 (w) (A1) 594 (h) x 420 (w) (A2)
Substrate:
Poster Paper, Banner Vinyl or polypropylene film.

ADDITIONAL:
Included in kit:
Base, Graphic Panel and securing bolt.



Tel: 01773 764288
E-mail: sales@phaseprint.com
www.phaseprint.com

We are continually improving and modifying our product range and reserve the right to vary the specifications without prior notice. All dimensions and weights quoted are approximate and we accept no responsibility for variance. E&OE.



SWINGER POSTER

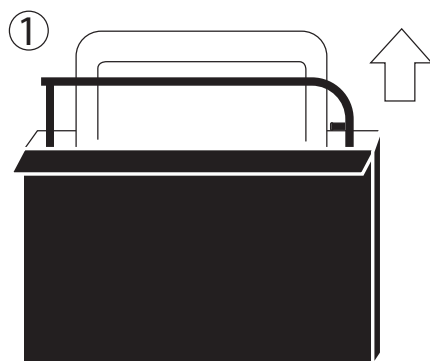

Base must be filled with
18 litres of water

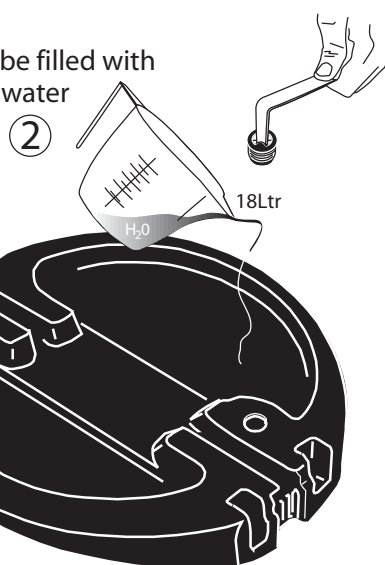

These cut outs in the base
fit over the wheels on the frame

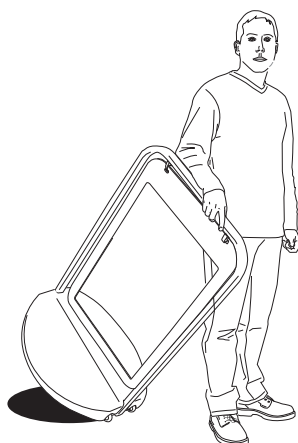
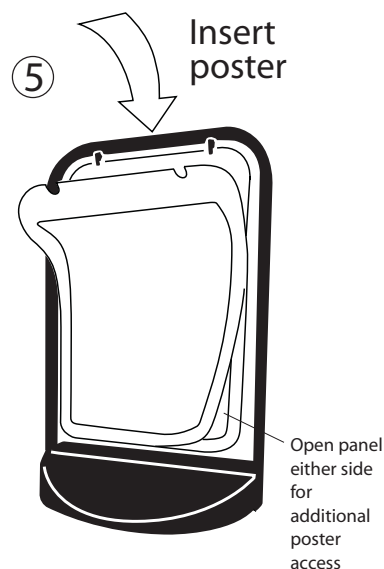
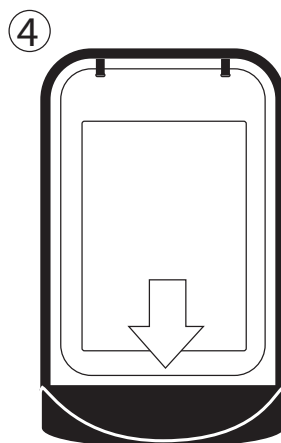
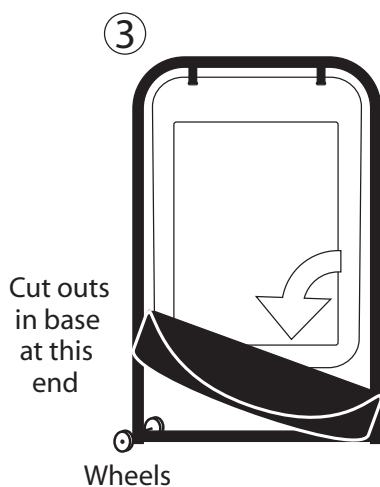

Once assembled, the whole sign can be easily
moved without the need to remove the base.

We wish to point out that it is the responsibility of the shop owner/user to ensure
that the siting of this pavement sign complies with all the local By Laws and Highway Regulations.

EXCLUSIVE TO
PHASE

Tel: 01773 764288
E-mail: sales@phaseprint.com
www.phaseprint.com

We are continually improving and modifying our product range and reserve the right to vary the specifications without prior notice. All dimensions and weights quoted are approximate and we accept no responsibility for variance. E&OE.

**DESIGN
PRINT
SIGNAGE**